

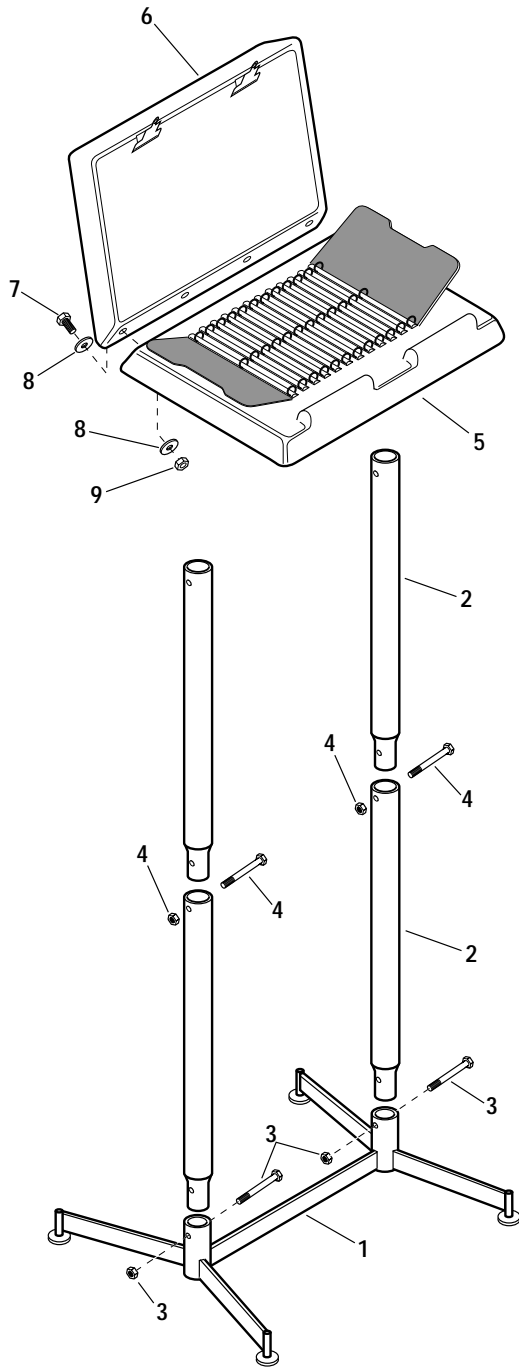

Assembly Instructions 1700S Catalog Display Stand



NOTE: This stand may be assembled with writing surface (item 5) at a height suitable for either standing use or seated use. To assemble for seated use, substitute 11" long post section for 22 1/2" long section (item 2).

Refer to illustration at left. *NOTE: The unit you are assembling may look slightly different than the illustration.*

1. Identify posts for stand (item 2).
2. Slide ends of lower posts (2) onto base (1). Secure with screws and nuts (3). Tighten. Slide upper posts into tops of lower posts. Secure with screws and nuts (4). Tighten.
3. Snap glides into base.
4. Slide sleeves beneath catalog display panel (5) onto top of stand. Secure with screw and nut in each sleeve (C on detail 1).
5. Assemble upper display panel (6) to catalog display panel (5) using bolts, flat washers and hex nuts (7, 8, 9). Tighten securely.

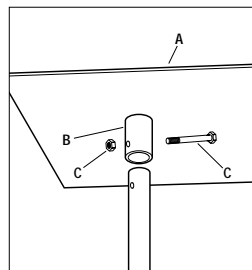

-Detail 1-
Assembling catalog
display panel to post.



Workplace Solutions

P.O. Box 26 • 600 South Clark St.
Mayville, WI 53050
Phone: 920-387-4120
Fax: 920-387-4189