

Assembly Instructions 2700D Inspection Stand

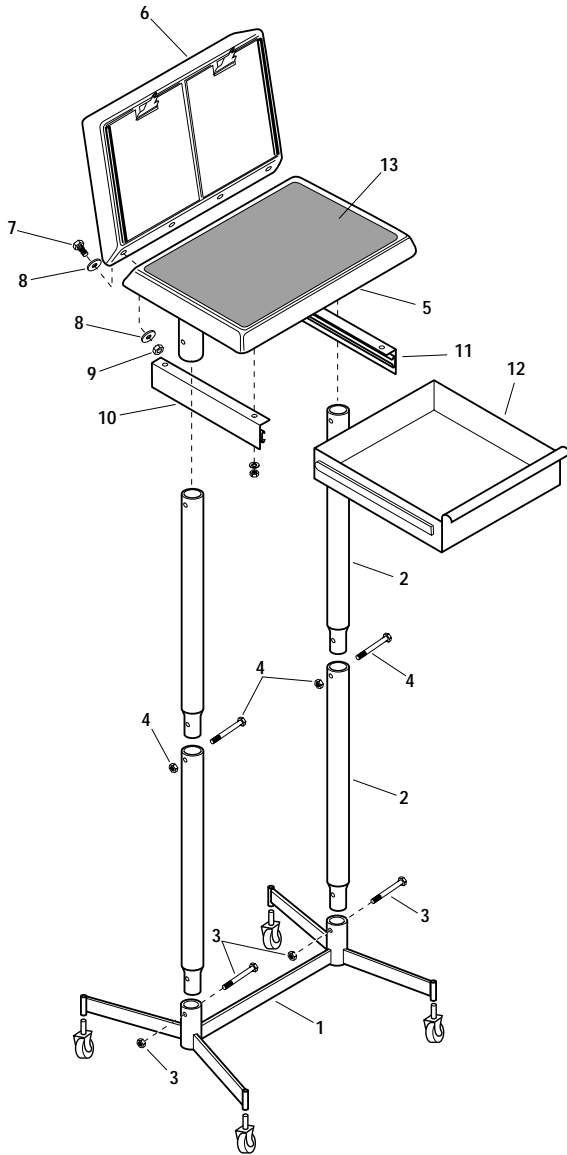

NOTE: This stand may be assembled with writing surface (item 5) at a height suitable for either standing use or seated use. To assemble for seated use, substitute 11" long post section for 22 1/2" long section (item 2).

Refer to illustration at left. *NOTE: The unit you are assembling may look slightly different than the illustration.*

1. Identify posts for stand (items 2).
2. Snap casters into base (1).
3. Slide ends of lower posts (2) onto base (1). Secure with screws and nuts (3). Tighten. Slide upper posts into tops of lower posts. Secure with screws and nuts (4). Tighten.
4. Remove the four 1/4" - 20 nuts from plate on underside of 20" x 26" inspection panel (5). Mount drawer adapters (10 & 11) to plate and replace nuts.
NOTE: Mounting flanges of adapters must be facing each other.
5. Slide inspection panel (5) onto top of stand posts (detail 1). Secure with screw and nut in each sleeve (C on detail 1). Tighten
6. Slide drawer (12) into glide mechanisms on drawer adapters (10 & 11).
NOTE: make sure ball bearings are fully engaged and not cocked or drawer will not stay in grooves.
7. Attach display panel (6) to inspection panel (5) using four bolts, flat washers and hex nuts (7, 8, 9). Tighten securely.
8. Install neoprene pad (item 13) on inspection panel.
9. Remove protective sheets from clear acrylic covers by running knife blade along edge of hinge and stripping off tinted plastic.

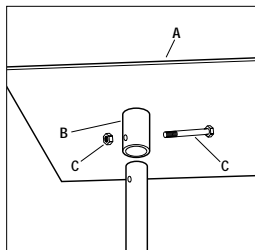

-Detail 1-
Assembling inspection
panel to post.



Workplace Solutions

P.O. Box 26 • 600 South Clark St.
Mayville, WI 53050
Phone: 920-387-4120
Fax: 920-387-4189