

Assembly Instructions 2700S Inspection Stand

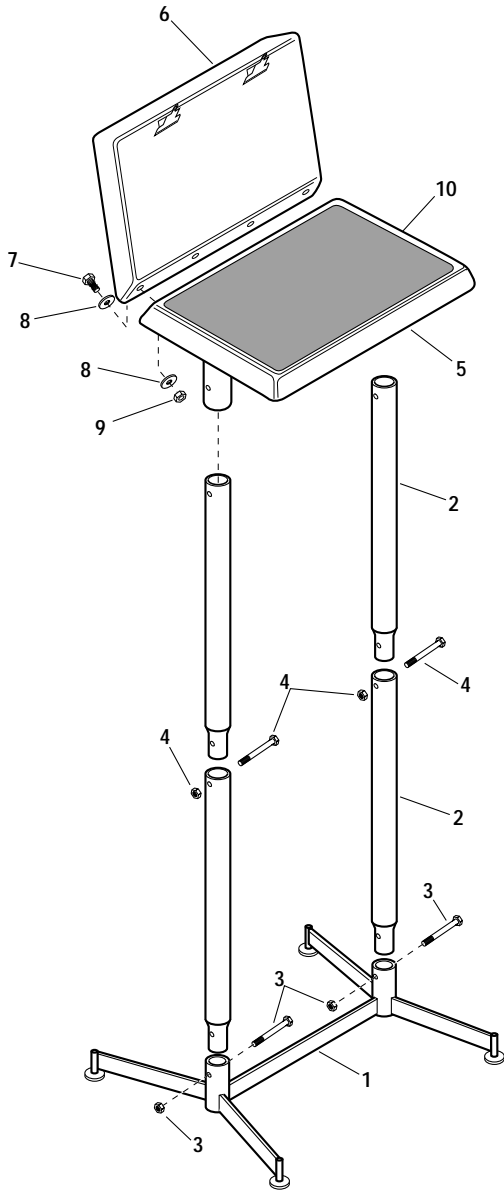

NOTE: This stand may be assembled with writing surface (item 5) at a height suitable for either standing use or seated use. To assemble for seated use, substitute 11" long post section for 22 1/2" long section (item 2).

Refer to illustration at left. *NOTE: The unit you are assembling may look slightly different than the illustration.*

1. Identify posts for stand (items 2).
2. Snap glides into base (1).
3. Slide ends of lower posts (2) onto base (1). Secure with screws and nuts (3). Slide upper posts into tops of lower posts. Secure with screws and nuts (4). Tighten.
4. Slide inspection panel (5) onto top of stand posts (detail 1). Secure with screws and nuts (C on detail 1). Tighten.
5. Assemble display panel (6) to inspection panel (5) using four bolts, flat washers and hex nuts (7, 8, 9). Tighten securely.
6. Install neoprene pad (10) on inspection panel.

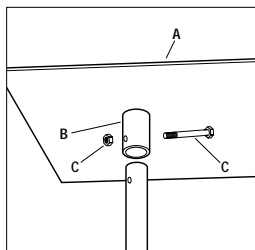

-Detail 1-
Assembling writing
surface to post.



Workplace Solutions

P.O. Box 26 • 600 South Clark St.
Mayville, WI 53050
Phone: 920-387-4120
Fax: 920-387-4189

Part No. 2692.b